

THE HARBOR AT LAKEWAY
AN ASSISTED LIVING AND MEMORY CARE COMMUNITY
300 MEDICAL PARKWAY
LAKEWAY, TX 78734



LEFT WING
SEE ENLARGED FLOOR PLAN A1.3
SEE ENLARGED DIMENSION PLAN A1.9

MIDDLE WING
SEE ENLARGED FLOOR PLAN A1.4
SEE ENLARGED DIMENSION PLAN A1.10

RIGHT WING
SEE ENLARGED FLOOR PLAN A1.5
SEE ENLARGED DIMENSION PLAN A1.11

BUILDING GENERAL NOTES

- OWNER SHALL PROVIDE PORTABLE FIRE EXTINGUISHERS PER LOCAL FIRE MARSHAL. GENERAL CONTRACTOR TO INSTALL.
- BUILDING ADDRESS NUMBERS SHALL BE A MINIMUM 12" HIGH AND BE OF CONTRASTING COLORS.
- VERIFY THAT ALL WORK PERFORMED UNDER THIS CONTRACT IS DONE IN COMPLIANCE WITH APPLICABLE CODES.
- CONTACT ARCHITECT IF CONDITIONS OTHER THAN THOSE REPRESENTED ON THE DRAWINGS ARE ENCOUNTERED.

ROOM DISTRIBUTION					
ROOM TYPE	ROOMS			TOTAL	BEDS
	SQ. FT.	1ST FL.	2ND FL.		
MC STUDIO	296	40	0	40	40
STUDIO	369	9	22	31	31
1-BEDROOM	482	9	34	43	43
2-BEDROOM	851	7	11	18	36
TOTAL				132	150
FLOOR AREA		58,706	51,252	109,958	

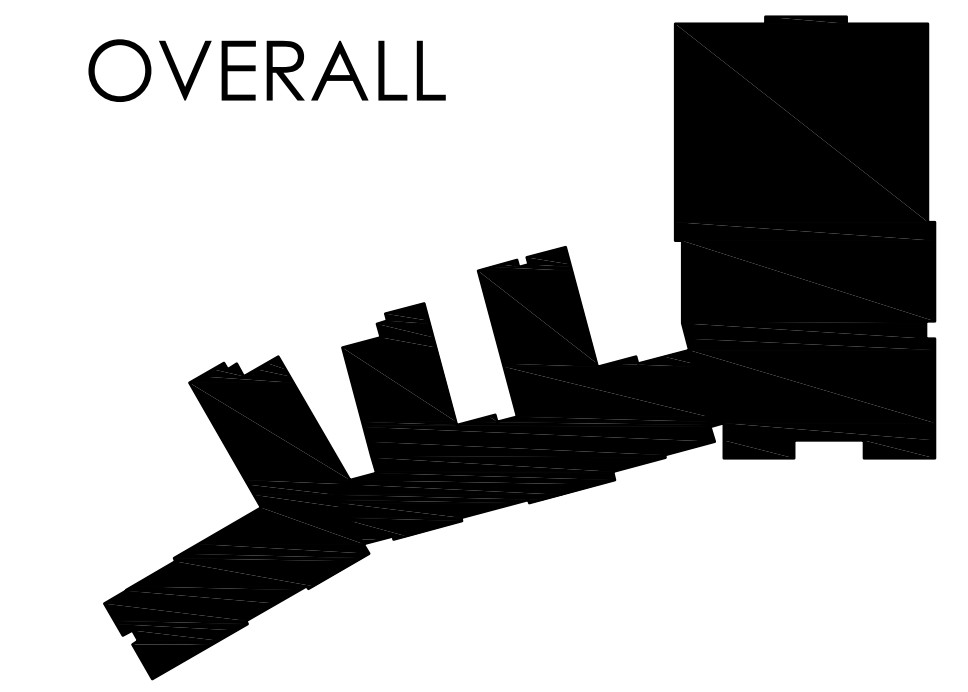

OVERALL

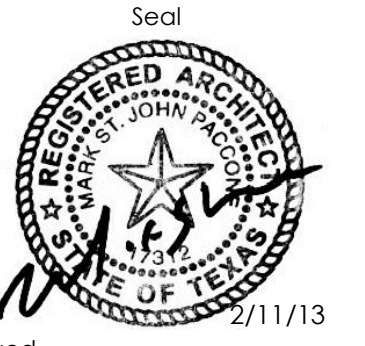

Issued 2/22/13
ISSUED FOR PERMIT

Revisions
2/22/13 | 1 - UPDATED SHEET

OVERALL FIRST FLOOR PLAN

Sheet No.
A1.1